



Description: Round recessed LED downlight with direct light.

Body: body in die-cast aluminum, painted white with epoxy powders UV stabilized, thermosetting at 180 ° C, after degreasing treatment, phosphating and washing. The device is supplied complete with brackets for fixing to the countertop.

Optical group: internal reflector in metallized aluminum and VTR diffuser in transparent glass.
Protection degree **IP44 / 20** (IP44 on the visible part, IP20 on the embedded part).

Wiring: power supply 220-240V 50 / 60Hz with rigid cable, sect. 0.50 mm² and PVC sheath resistant to 90 ° C according to CEI 20-20 standards.
Insulation class II.
Suitable for installation on normally flammable surfaces.

- LED version with fixed output electronic driver for independent use, included
- DALI LED dimmable version, with standard digital dimmable electronic driver DALI for independent use, included.

On request available:

- Versions with 1/3 hour autonomy emergency kit.

Luminous source: High efficiency LEDs arranged on rigid modules, color rendering CRI > 80 (CRI > 90 available on request), color temperature 3000K or 4000K (LED diode selected 3 MacAdam ellipses in order to guarantee uniform chromaticity), duration > 50000 hours L80 / F10 at Ta = 25 ° C.

Regulations: appliance complies with the following standards:

- | | | |
|---|--|---|
| <ul style="list-style-type: none"> • EN 61547 • EN 55015 • EN 61000-3-2 • EN 61000-3-3 • EN 61347-1 • EN 61347-2-13 | <ul style="list-style-type: none"> • IEC/TR 62471-2 • EN 60061-1 • EN 62031 • EN 62493 • EN 60598-1 • EN 60598-2-1 | <ul style="list-style-type: none"> • EN 60598-2-2 • EN 62471 • EN 62560 • EN 60968 • CEI 76-10 • EN 60529 |
|---|--|---|



Demonstration image

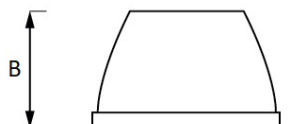
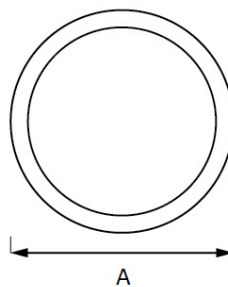
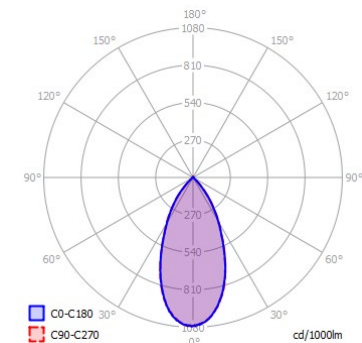
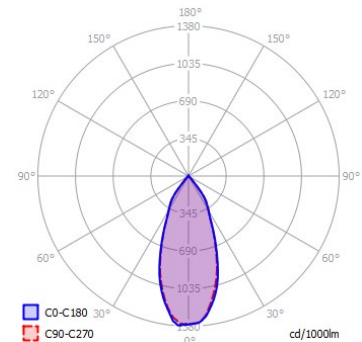

Diameter 120 mm

Power [W]	Color temperature [K]	CRI	Effective flux [lm] *	Efficiency [lm/W]	Energetic class	Dimensions [mm]			Code / Wiring	
						A	B	∅ recessed	LED	LED DALI
15	3000K	>80	1773	118	A++	120	70	105	575000008	575000009
15	4000K	>80	1845	123	A++	120	70	105	575000014	575000015
20	3000K	>80	2471	123	A++	120	70	105	575000010	575000011
20	4000K	>80	2574	128	A++	120	70	105	575000016	575000017
28	3000K	>80	3362	120	A++	120	70	105	575000012	575000013
28	4000K	>80	3501	125	A++	120	70	105	575000018	575000019

Diameter 160 mm

Power [W]	Color temperature [K]	CRI	Effective flux [lm] *	Efficiency [lm/W]	Energetic class	Dimensions [mm]			Code / Wiring	
						A	B	∅ recessed	LED	LED DALI
20	3000K	>80	2471	125	A++	160	100	148	575000020	575000021
20	4000K	>80	2574	128	A++	160	100	148	575000026	575000027
28	3000K	>80	3362	120	A++	160	100	148	575000022	575000023
28	4000K	>80	3501	125	A++	160	100	148	575000028	575000029
35	3000K	>80	4203	120	A++	160	100	148	575000024	575000025
35	4000K	>80	4383	125	A++	160	100	148	575000030	575000031

Diameter 205 mm

Power [W]	Color temperature [K]	CRI	Effective flux [lm] *	Efficiency [lm/W]	Energetic class	Dimensions [mm]			Code / Wiring	
						A	B	∅ recessed	LED	LED DALI
20	3000K	>80	2471	123	A++	205	100	188	575000032	575000033
20	4000K	>80	2574	128	A++	205	100	188	575000038	575000039
28	3000K	>80	3362	120	A++	205	100	188	575000034	575000035
28	4000K	>80	3501	125	A++	205	100	188	575000040	575000041
40	3000K	>80	4806	120	A++	205	100	188	575000036	575000037
40	4000K	>80	5004	125	A++	205	100	188	575000042	575000043

Diameter 230 mm

Power [W]	Color temperature [K]	CRI	Effective flux [lm] *	Efficiency [lm/W]	Energetic class	Dimensions [mm]			Code / Wiring	
						A	B	∅ recessed	LED	LED DALI
20	3000K	>80	2471	123	A++	230	117	218	575000044	575000045
20	4000K	>80	2574	128	A++	230	117	218	575000050	575000051
28	3000K	>80	3362	120	A++	230	117	218	575000046	575000047
28	4000K	>80	3501	125	A++	230	117	218	575000052	575000053
42	3000K	>80	4806	120	A++	230	117	218	575000048	575000049
42	4000K	>80	5004	125	A++	230	117	218	575000054	575000055
50	3000K	>80	5661	113	A++	230	117	218	575000056	575000057
50	4000K	>80	5904	118	A++	230	117	218	575000058	575000059

* Actual flow may have a tolerance of ± 10%.